



BELGRAVIA (E)

- Demountable acoustical ceiling
- Installation in recessed T-grid
- Edge E+

CONDITIONS OF USE

- For internal fitout of buildings
- To be installed in a closed-off building

STORAGE

The products must be:

- stored indoors clean and dry
- positioned on a level base
- protected from direct moisture
- stored at humidities of less than 70% RH and temperatures of less than 50°C
- protected from impact and shock
- stacked max. 2 pallets on top of each other

PACKAGING OPENING

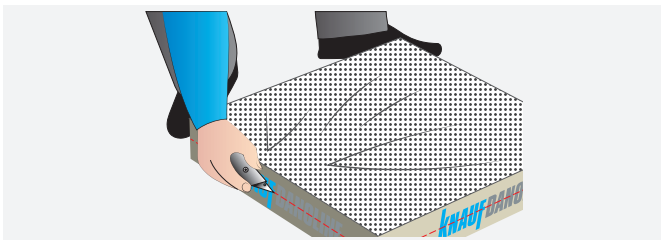

- Cut the plastic wrapping by running a knife along the sides of the package. Do not cut the plastic on top of the package.

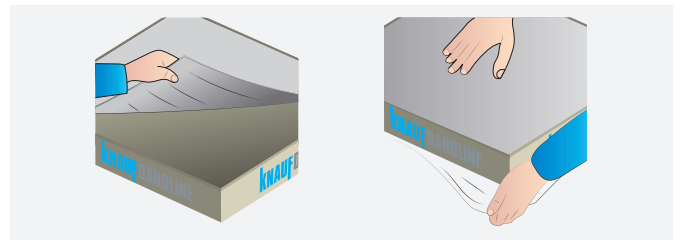

- Remove the plastic wrapping.

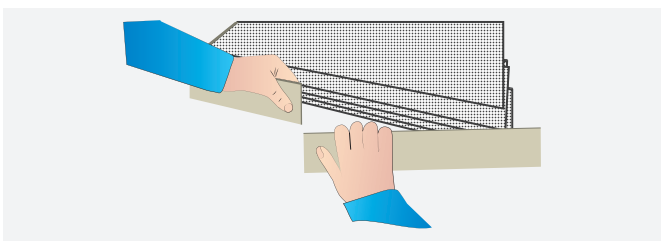

- Remove the cardboard liner around the ceiling tiles.





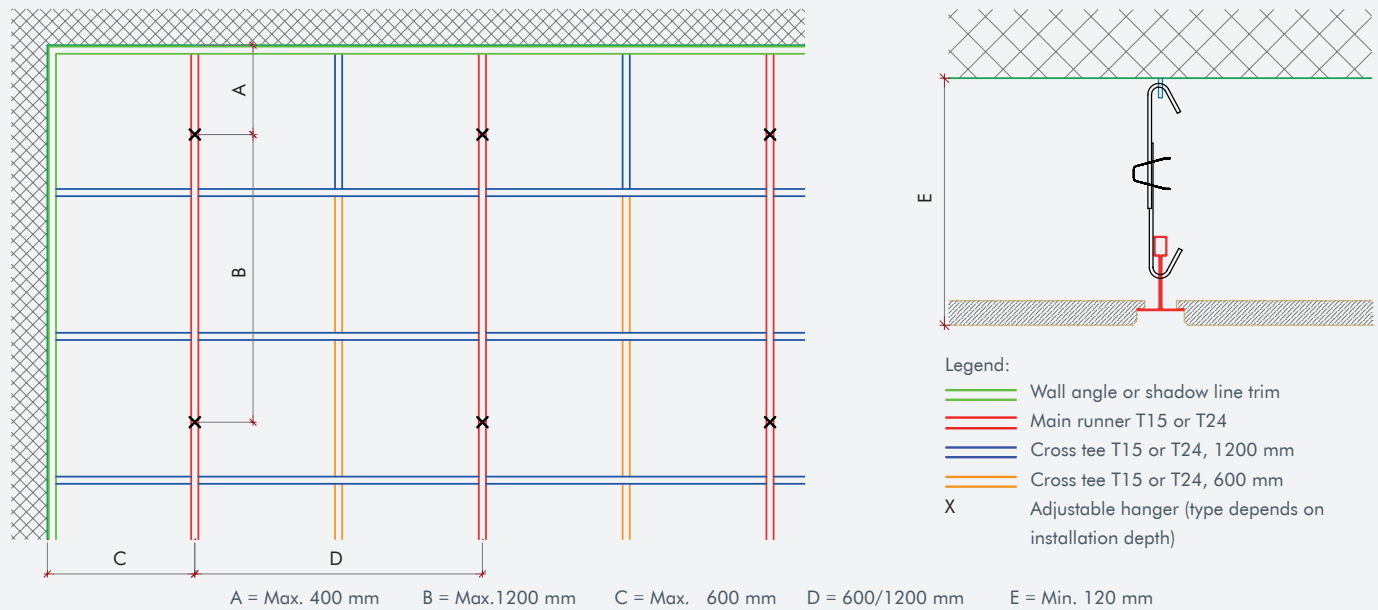



INSTALLATION GUIDE BELGRAVIA (E)

CEILING LAYOUT

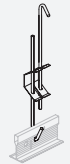

RECOMMENDED ACCESSORIES

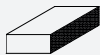
Below accessories are tested and approved for use in connection with Belgravia.

	PRODUCT NAME	SAP NO.	W x L x H (mm)
	 Main runner T24 , or Main runner T15	467385 593513	24 x 3700 x 38 15 x 3700 x 38
	 Cross tee T24 , or Cross tee T15	467388 467389 593507 593510	24 x 600 x 38 24 x 1200 x 38 15 x 600 x 38 15 x 1200 x 38
T-grid	 Adjustable hanger The size specification indicates the min. and max. range	469861 469868 469872 469876 469878 469880 469881	165 - 280 315 - 580 510 - 970 630 - 1210 755 - 1460 900 - 1750 1020 - 1990
	 Wall angle type MIE2024	434023	20 x 3000 x 24
	 Shadow line trim type MS15	316335	15+15x3000/8+25
	 Outside corner for wall angle Outside corner for shadow line trim	109100 316310	
	 Inside corner for wall angle Inside corner for wall angle	109102 316312	
Extra	 DANOpur - Extra sound absorption and reduction as backing. Mineral wool backing sealed in plastic bags. No risk of dust particles.		600 x 600 x 25 mm 600 x 600 x 50 mm
	 Plug for Belgravia w/24 mm T-profiles in wall angle 434023	430801	
	 Hold down clip	430744	-
	 Repair kit White paint for preprinted tiles	198956	100 mm NCS 0700

INSTALLATION GUIDE BELGRAVIA (E)

INSTALLATION

Before installation, please ensure that fixtures to primary construction can withstand the load of the ceiling.
Best Practice: Use of clean cotton gloves when handling product tiles will ensure a good result and a ceiling without fingermarks.

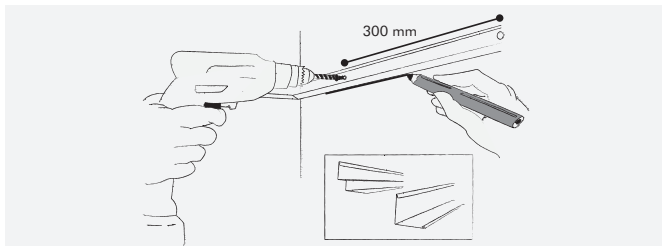

WALL ANGLES

- Mark the location of the wall angles on the walls and columns in relation to the required ceiling height.
- Fix the wall angles at max. 300 mm c/c. Choose the fixings in accordance with the substrate.

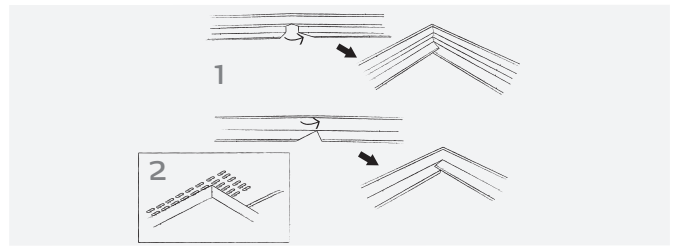

CORNERS

- Inside corners (1): cut the corners in a false mitre letting the ends overlap each other, unless anything to the contrary is specified.
- Outside corners (2): must always be mitred.

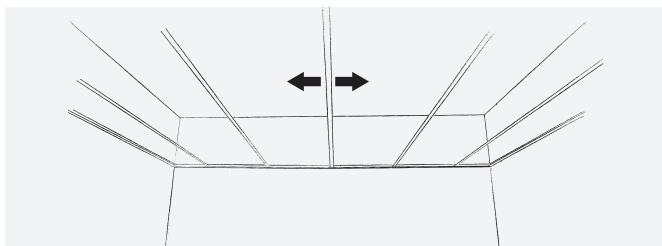

CEILING LAYOUT

- Divide the ceiling surface from the centre of the room or in accordance with the existing ceiling plans.
- The location of light fittings and ventilation units will have an influence on ceiling layout.
- The first main runner is installed at max. 600 mm from the wall. The other main runners should be installed at 600/1200 mm c/c.

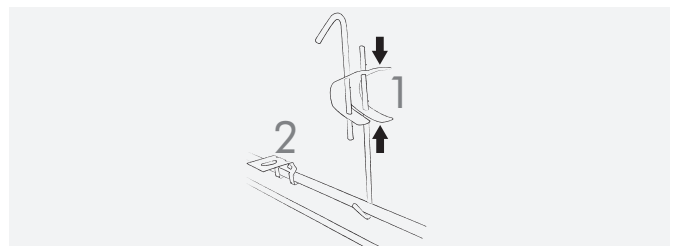

HANGERS

- Fix adjustable hangers (1) with eye screws or similar securely fastened to the primary construction.
- Direct hangers (2) are secured to the ceiling using appropriate fixings in accordance with the substrate.
- Install the first hanger at max. 400 mm from the wall. The other hangers should be installed at max. 1200 mm c/c.
- If loads from light fittings etc. are to be borne by the ceiling, install additional hangers.
- Refer to distances in the ceiling layout drawing.

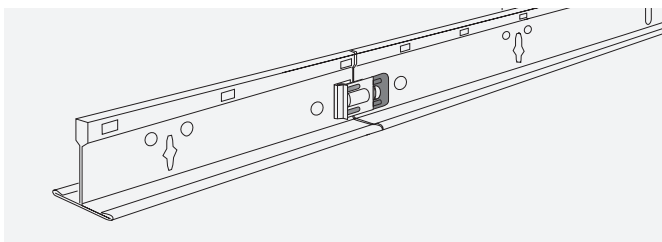

MAIN RUNNERS

- Install the main runners parallel to each other so that the slots are directly opposite each other.
- Join the main runners longitudinally by clicking them together.
- Adjust the lengths of the profiles with plate shears, a hacksaw or a cross-cut saw with a special blade.
- Make sure there is a hanger between the end joints of the main runners and the fire break.

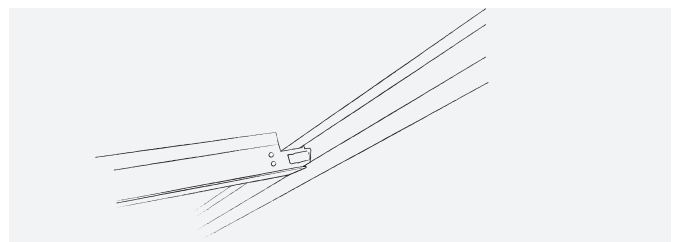

CROSS PROFILES

- Push the snap-in tongue into the slot on the main runner until it securely clicks into place.
- If there is a cross profile on the opposite side of the main runner, the new one must be on the left hand side of the one already in place.

INSTALLATION GUIDE BELGRAVIA (E)

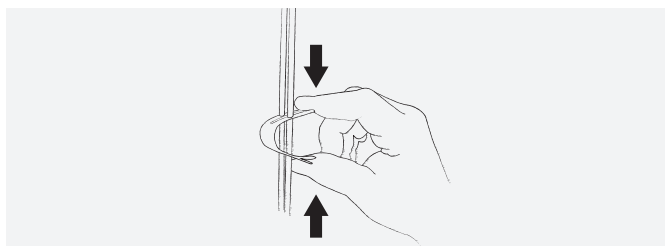

ADJUSTMENT

- Check that all profiles are correctly aligned when the entire suspension grid has been installed.
- Adjust the hangers so that they are taut and the ceiling surface is level.

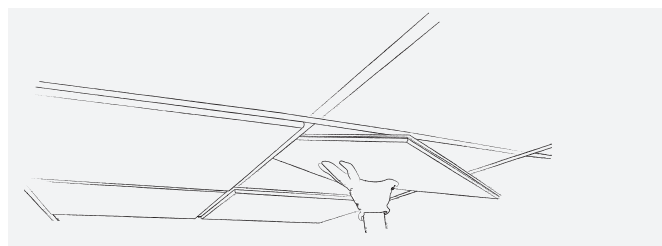

INSTALLATION

- Always wear clean cotton gloves when handling ceiling tiles.
- Install the tiles by tilting them up between the T-profiles.

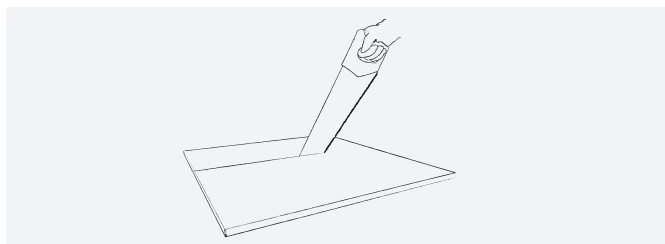

CUTTING

- Cut the tiles to size from the front face with a fine-toothed saw.

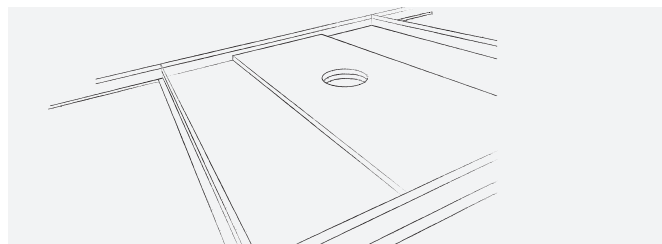

FIXTURES AND FITTINGS

- The reinforcement tile must extend all the way into the main runners, so that the weight is transferred to them.
- The total weight should not be greater than 3kg for each m² of ceiling. Where loads are greater than 3kg/m², additional hangers must be used.
- Units over 3kg, must be installed independently, so that they do not place any load on the ceiling.